

NO.	DESCRIPTION	AREA (SQ.M)
1	COVERED AREA	18445.50
2	OPEN AREA	18445.50
3	TOTAL AREA	36891.00
4	LAND AREA (AS PER PLAN)	36891.00
5	LAND AREA (AS PER SITE PLAN)	36891.00
6	LAND TO BE DEVELOPED	36891.00
7	LAND TO BE DEVELOPED (NET)	36891.00
8	LAND TO BE DEVELOPED (GROSS)	36891.00
9	LAND TO BE DEVELOPED (NET) (MINUS)	36891.00
10	LAND TO BE DEVELOPED (NET) (MINUS)	36891.00
11	LAND TO BE DEVELOPED (NET) (MINUS)	36891.00
12	LAND TO BE DEVELOPED (NET) (MINUS)	36891.00
13	LAND TO BE DEVELOPED (NET) (MINUS)	36891.00
14	LAND TO BE DEVELOPED (NET) (MINUS)	36891.00
15	LAND TO BE DEVELOPED (NET) (MINUS)	36891.00
16	LAND TO BE DEVELOPED (NET) (MINUS)	36891.00
17	LAND TO BE DEVELOPED (NET) (MINUS)	36891.00
18	LAND TO BE DEVELOPED (NET) (MINUS)	36891.00
19	LAND TO BE DEVELOPED (NET) (MINUS)	36891.00
20	LAND TO BE DEVELOPED (NET) (MINUS)	36891.00

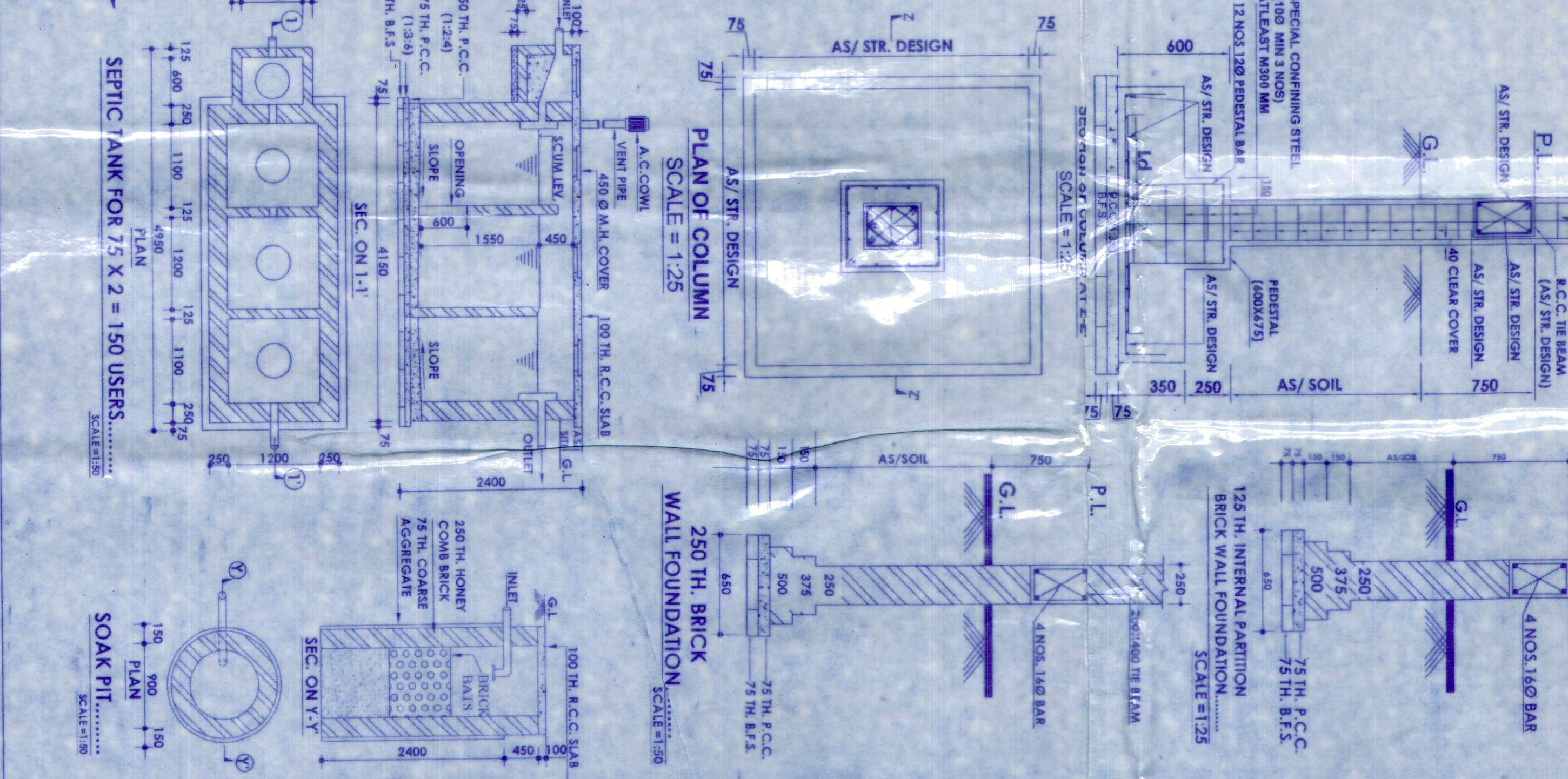
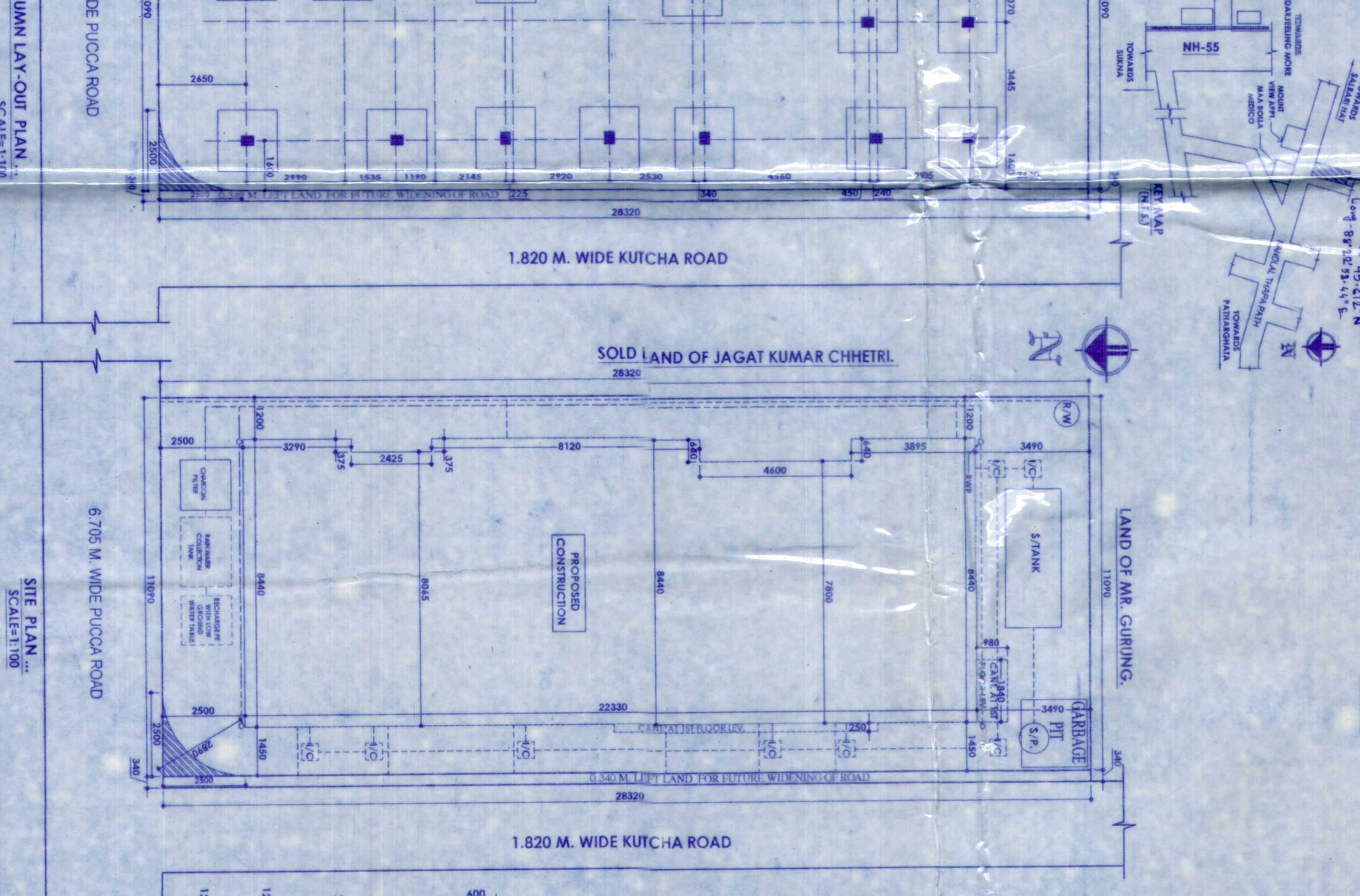
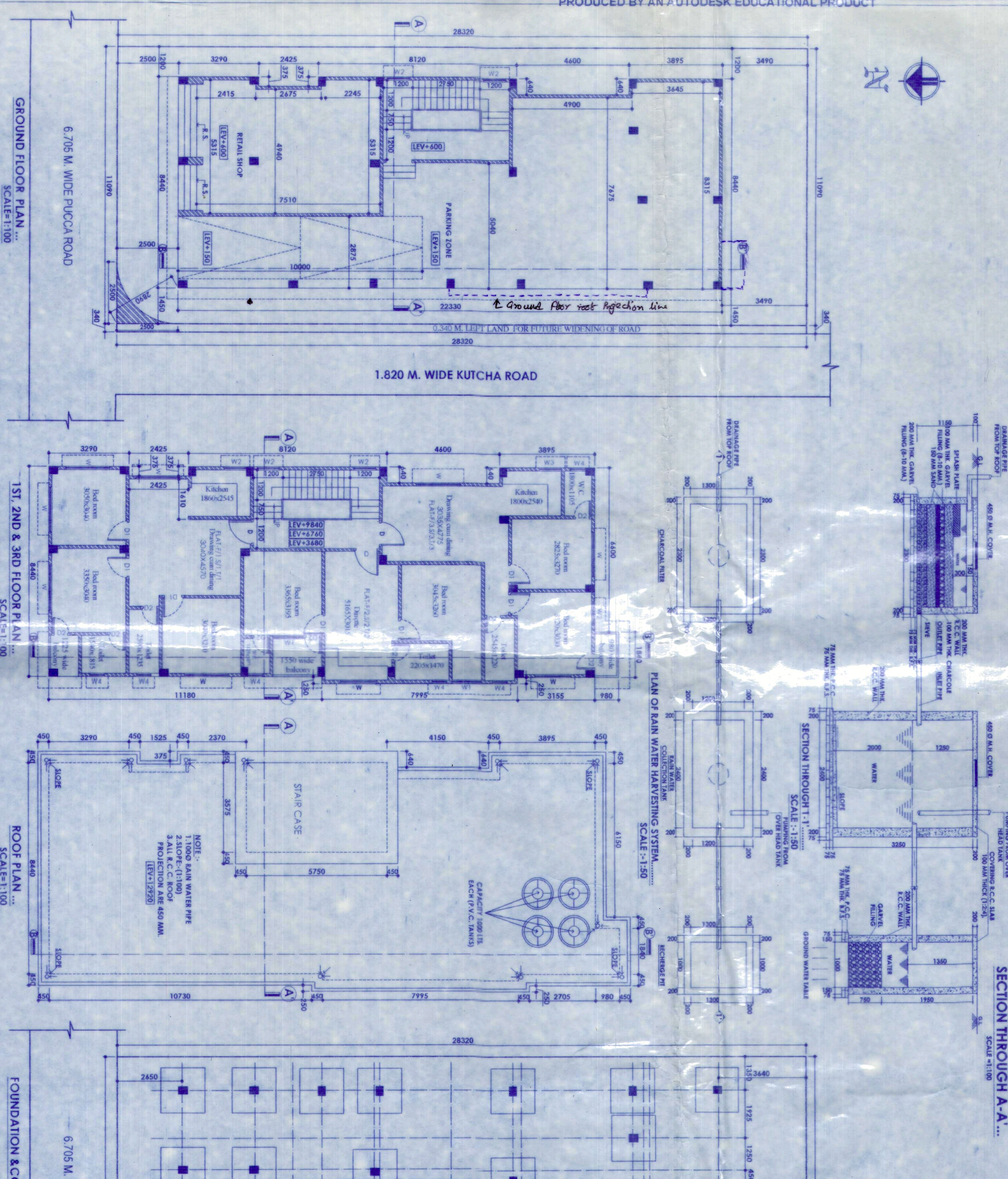

AREA STATEMENT

NO.	DESCRIPTION	AREA (SQ.M)
1	COVERED AREA	18445.50
2	OPEN AREA	18445.50
3	TOTAL AREA	36891.00
4	LAND AREA (AS PER PLAN)	36891.00
5	LAND AREA (AS PER SITE PLAN)	36891.00
6	LAND TO BE DEVELOPED	36891.00
7	LAND TO BE DEVELOPED (NET)	36891.00
8	LAND TO BE DEVELOPED (GROSS)	36891.00
9	LAND TO BE DEVELOPED (NET) (MINUS)	36891.00
10	LAND TO BE DEVELOPED (NET) (MINUS)	36891.00
11	LAND TO BE DEVELOPED (NET) (MINUS)	36891.00
12	LAND TO BE DEVELOPED (NET) (MINUS)	36891.00
13	LAND TO BE DEVELOPED (NET) (MINUS)	36891.00
14	LAND TO BE DEVELOPED (NET) (MINUS)	36891.00
15	LAND TO BE DEVELOPED (NET) (MINUS)	36891.00
16	LAND TO BE DEVELOPED (NET) (MINUS)	36891.00
17	LAND TO BE DEVELOPED (NET) (MINUS)	36891.00
18	LAND TO BE DEVELOPED (NET) (MINUS)	36891.00
19	LAND TO BE DEVELOPED (NET) (MINUS)	36891.00
20	LAND TO BE DEVELOPED (NET) (MINUS)	36891.00

DECLARATION BY THE OWNER

I, the undersigned, being the owner of the above described land, hereby declare that the above mentioned details are true and correct and that the same are in accordance with the provisions of the relevant laws and regulations. I further declare that the above mentioned details are in accordance with the provisions of the relevant laws and regulations. I further declare that the above mentioned details are in accordance with the provisions of the relevant laws and regulations.

SIGNATURE OF OWNER

Rishabh Adhikari

SIGNATURE OF ARCHITECT

Er. Sorren Mitta

DATE

12/12/2024